

Inspection Picture of the Month:

"No Vapor-Barrier on the Crawlspace Floor" – How many times have we seen this?

With a crawlspace over a living area, it is very important to place a plastic vapor barrier sheeting between the exposed soil and the open crawlspace. This sheeting acts as a moisture barrier, preventing natural moisture in the soil from leaching into the crawlspace area, and potentially causing mold growth to occur.

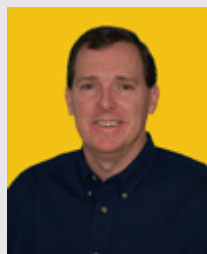

George Scott

Owner-Inspector

**Scott Home
Inspection, LLC**

In addition to the prevention of mold, the vapor barrier helps with the insulating and sealing of the crawlspace, making the living area above more energy efficient and more comfortable.

"You have my personal commitment that I will work to provide the best home inspection experience possible for each customer."

Cover crawlspace floor

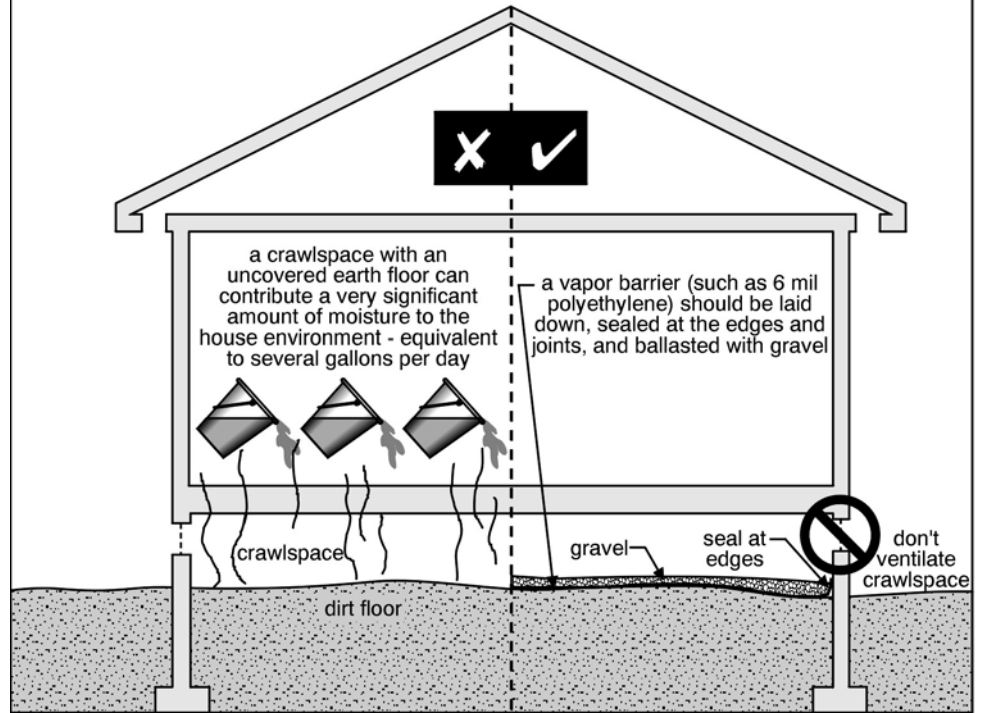

Proper foundation wall insulation is also critical in a crawlspace. This insulation should cover the foundation walls as well as the rim-joint area. Typically, insulating the walls provides for a more comfortable environment that just insulating the sub-floor alone.

Insulating crawlspaces

heated crawlspace - preferable

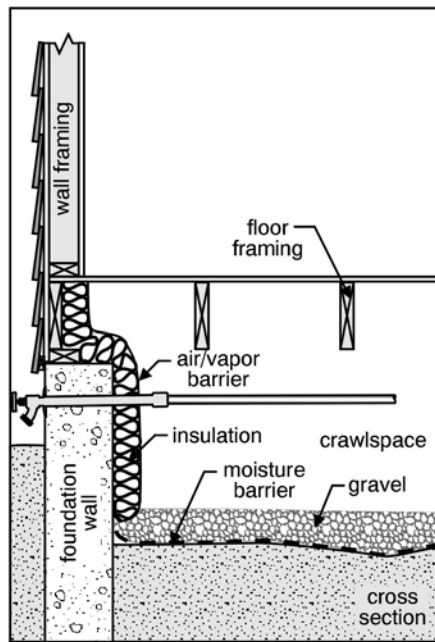

unheated crawlspace

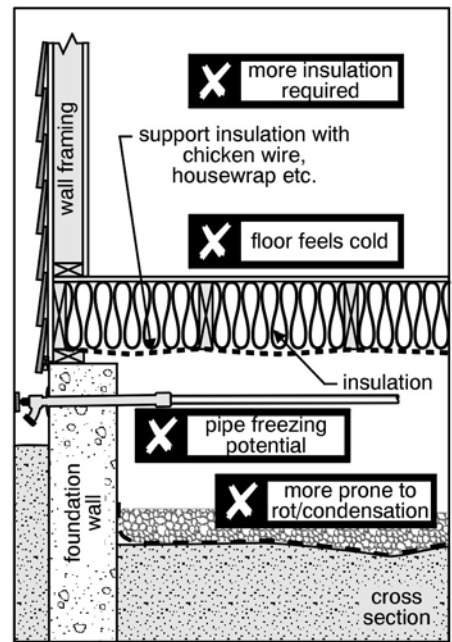

News:

Scott Home Inspection is now **HUD Certified to perform Multi-Family inspections**. This week-long training in Washington DC was completed in August. The added knowledge and training will also help with Single-Family, Condominium and Townhouse inspections.

Home-Tips On-Line:

www.scotthomeinspection.com/hometips.html

More Information about our Services:

- [*View our Services*](#)
- [*View a Sample Report*](#)
- [*Review our Fees*](#)
- [*View Schedule Availability*](#)

Contact Info:

Scott Home Inspection, LLC

970-532-2424 –or- 720-979-4960

george@scotthomeinspection.com

Visit our website!

www.scotthomeinspection.com